

LH103

特点和用途:

单点式铝合金制称重传感器。精度高、抗偏载能力强，结构简单，容易安装。适用于电子秤、计数秤、电子天平及工业称重系统。

Features & Applications:

Single-ended, aluminum Load Cell. High Accuracy, Good side load tolerance, Simple Structure, easy to install.

Mainly used for electronic scale, balance, price computing scale and industrial weighing system.

量程/Capacity:

0.5, 1, 2, 3, 5, 10, 15 kg

受力方式 Load Instruction

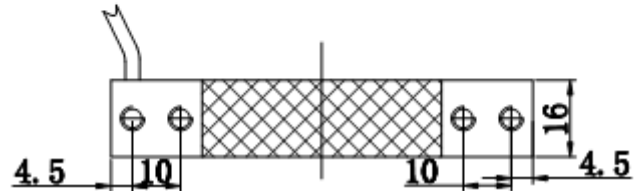
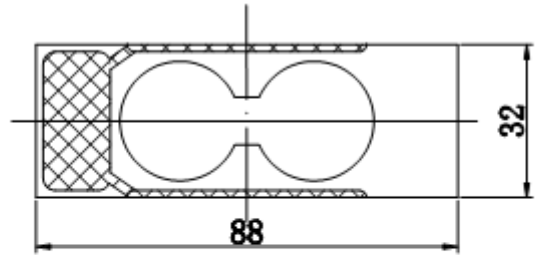
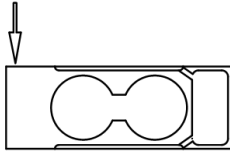

主要技术参数(Specification)					
输出灵敏度	Rated output	2.0 ± 10 % (1.0 mv / v / 0.5 kg) mV / V			
零点输出	Zero balance	± 2% F.S.	绝缘电阻)	Insulation	≥5000M Ω /100VDC
非线性	Non-linearity	0.02% F.S.	使用电压	Recommended excitation	10V
滞后)	Hysteresis	0.02 % F.S.	最大使用电压	Maximum excitation	15V
重复性)	Repeatability	0.02 % F.S.	温度补偿范围	Compensated temp.range	- 10 ~ 40 °C
蠕变 (30分钟)	Creep(30min)	0.03 % F.S.	工作温度范围	Operation temp. range	- 20 ~ 60 °C
温度灵敏度漂移	Temp effect on output	0.025 % F.S. / 10°C	安全超载	Safe overload	150 % F.S.
零点温度漂移	Temp effect on zero	0.025 % F.S. / 10°C	极限超载	Ultimate overload	300 % F.S.
输入电阻	input impedance	410 ± 10 Ω	电缆线尺寸	Cable size	Ø 3 × 400mm
输出电阻	Output impedance	350 ± 3 Ω	台面尺寸	Platform size	250 × 300mm
			防护等级	Protection Class	IP65
连接方式Cable Color Code			Input: Red(+) Black(-); Output: Green(+) White(-); 输入: 红 (+) 黑 (-); 输出: 绿 (+) 白 (-)		